

Varenummer: 252000400217
 Beskrivelse: ICME IE2 asynkronmotor THE 112M A2
 4kW 2920 o/min 230/400 B35

Mål

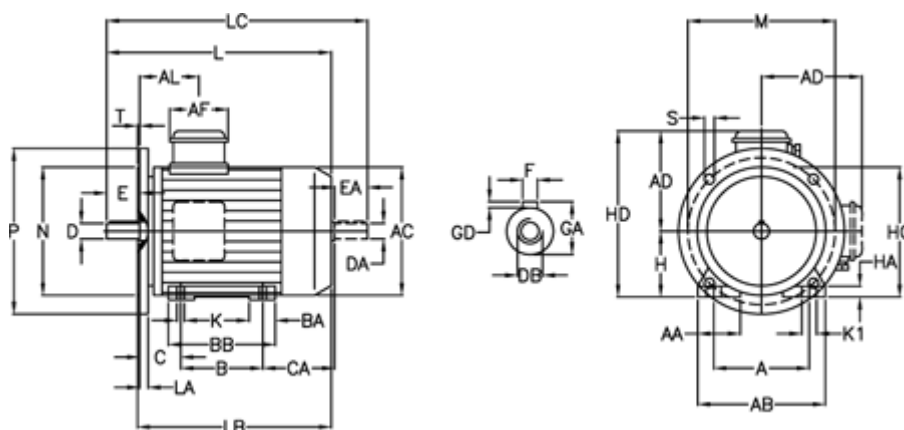

A = 190	BA = 38	EA = 60	K = 12	P = 250
A/F = 84	BB H7 = 176	F = 8	K1 = 21	S = 14
AA = 42	C = 70	GA = 31	L = 385	T = 4
AB = 220	CA = 118	GD = 7	LA = 14	
AC = 219	D = 28	H = 112	LB = 325	
AD = 160	DA = 28	HA = 15	LC = 448	
AL = 97	DB = M10	HC = 225	M = 215	
B = 140	E = 60	HD = 272	N = 180	